

# S110® PATCH PLUG

Siemon S110 patch plugs are both category 5e compliant and can be field-terminated to either solid or stranded cable. 4-pair S110 patch plugs employ a patented design to improve electrical isolation between pairs, enhancing cross-talk performance so that the mated plug and connecting block significantly exceed category 5e transmission requirements.

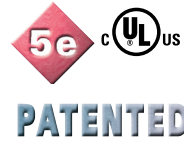

S110 PRODUCTS

Ergonomic handle aids insertion and removal of patch plug from 110 connect block

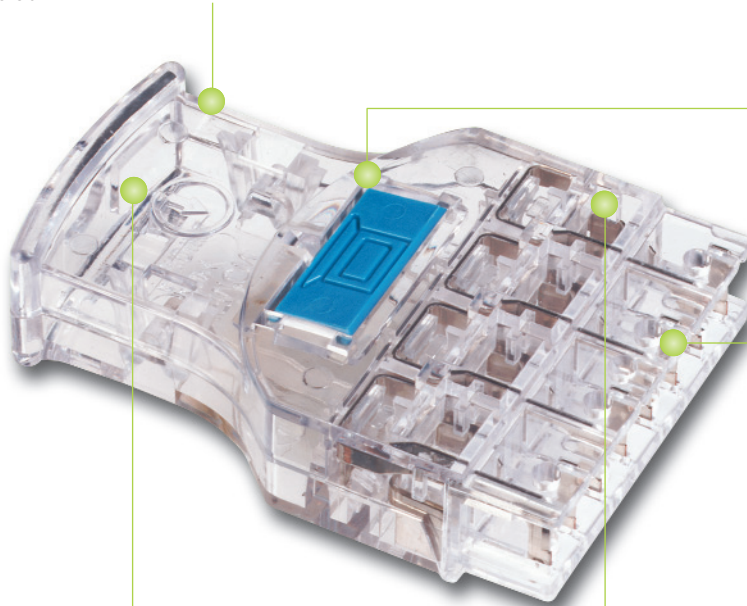

Optional colored icon tabs assist in color-coding 4-pair plugs

Each plug housing includes built-in polarization features to ensure proper tip-ring orientation during connection

Directional arrow provided assists in proper insertion orientation

Clear plastic housing allows the conductor colors and positions to be visible for matching termination positions on the opposite end

### Technical Tip!

When S110-to-modular plug cable assemblies are configured in the field, The Siemon Company recommends that Siemon MC® 5 modular patch cords be purchased and cut in half. The end of the cord can then be field terminated to the S110P patch plug while the factory terminated and tested modular plug end remains undisturbed

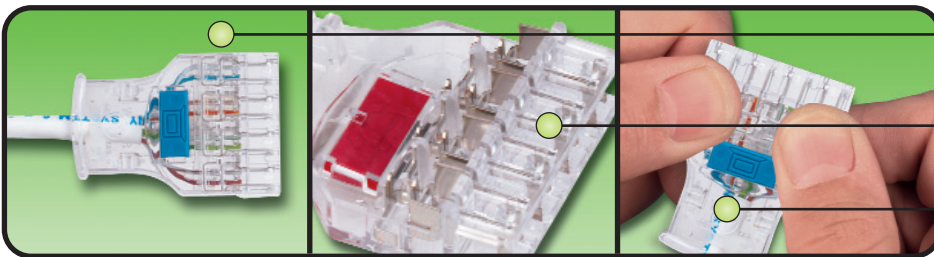

Terminates 24 to 26 AWG (0.40mm to 0.51mm) solid or 7-strand twisted-pair cable

Staggered contacts in bi-directional planes provide excellent pair-to-pair isolation, delivering component and channel performance to 160 MHz

Simply snap the base and cover together to mass terminate all conductors

CONNECTING THE WORLD TO A HIGHER STANDARD

WWW.SIEMON.COM



# ORDERING INFORMATION

S110 PRODUCTS

## S110® Patch Plugs:



S110P1\* .....  
1-pair, field-terminated, patch plug



S110P2 .....  
2-pair, field-terminated, patch plug

### ENHANCED

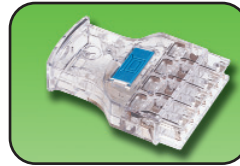

S110P4 .....  
4-pair, field-terminated, patch plug

☺ Add "B" to end of part number for bulk project pack of 100 plugs

\*S110P1 includes protective insert for use with single pair category 5e cross-connect wire

Colored Icons are not included. See related products below

## Factory-Terminated S110 Patch Cords:

- S110P1-P1-(XX) ..... 1-pair, double-ended stranded S110 patch cord, CMG
- S110P1-U1-(XX) ..... 1 pair, S110-to-modular 6-position plug, USOC, CMG
- S110P1-U4-(XX) ..... 1 pair, S110-to-modular 8-position plug, USOC, CMG
- S110P2-P2-(XX) ..... 2-pair, double-ended stranded S110 patch cord, CMG
- S110P2-UT-(XX) ..... 2-pair, S110-to-modular 8-position plug, Token Ring, T568A, CMG
- S110P2-E2-(XX) ..... 2-pair, S110-to-modular 8-position plug, 10/100BASE-T, T568B, CMG
- S110P4-A4-(XX) ..... 4-pair, S110-to-modular plug, T568B, CMG
- S110P4-T4-(XX) ..... 4-pair, S110-to-modular plug, T568A, CMG
- S110P4-P4-(XX) ..... 4-pair, double-ended stranded S110 patch cord, CMG

Use (XX) to specify length:

03 = 0.91m (3 ft.), 05 = 1.5m (5 ft.), 07 = 2.13m (7 ft.),  
10 = 3.05m (10 ft.), 15 = 4.57m (15 ft.), 20 = 6.10m (20 ft.)

Custom lengths and custom wiring configurations are available upon request. Contact our Customer Service Department for more information.



## Related Product:

- CT-ICON-(XX) ..... 25 colored icon tabs for 4-pair S110 patch plug (phone on one side, computer on reverse)
- TAB-(XX) ..... 25 colored blank tabs for 4-pair S110 patch plug

Use (XX) to specify color: 00=clear (TAB-(XX) only),  
01 = black, 02 = white, 03 = red, 04 = gray, 05 = yellow,  
06 = blue, 07 = green, 08 = violet, 09 = orange,  
20 = ivory, 25 = bright white, 60 = brown, 80 = light ivory

☺ Add "B" for bulk pack of 100\*



Because we continuously improve our products, Siemon reserves the right to change specifications and availability without prior notice.

S110®, MC® and Tower® are trademarks of Siemon

## For related product information request Spec Sheet(s):

- S110 Wiring Blocks (PROD-SS-110)
- S110 Modular Tower® System (PROD-SS-10M)

**The Americas**  
Watertown, CT USA  
Phone (1) 860 945 4200

**Europe/Middle East/Africa**  
Surrey, England  
Phone (44) 0 1932 571771

**Asia/Pacific**  
Shanghai, P.R. China  
Phone (86) 21 6390 6778

**Japan**  
Tokyo, Japan  
Phone (81) (3) 5437 1580

WWW.SIEMON.COM

ISO 9001  
CERTIFIED

ISO 14001  
CERTIFIED



PROD-SS-TOP Rev. K 5/11

© 2011 Siemon