

# Modular Furniture Bracket Instructions

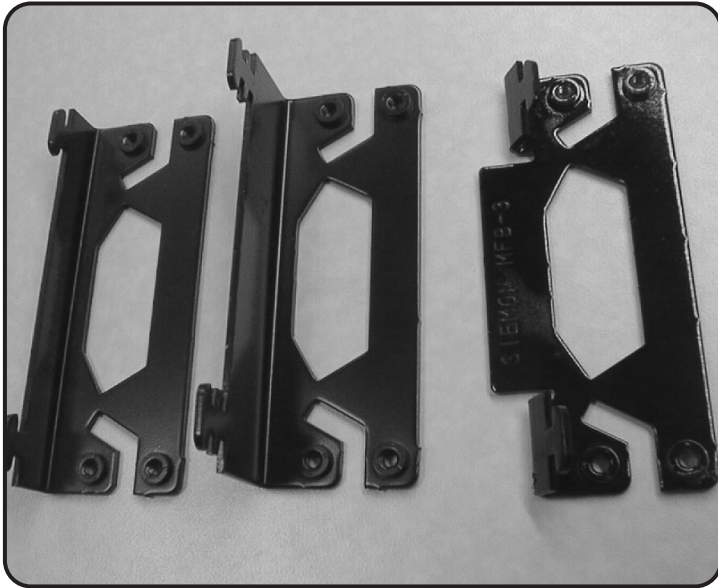

## Bracket Mounting with Surface Mount Boxes...

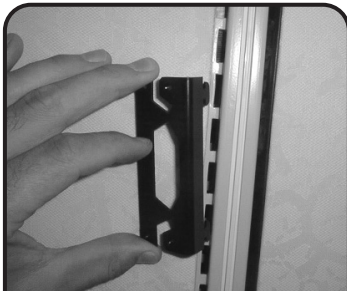

**1** Insert bracket tabs into the furniture channel slots at the desired height.

*Note: Version shown is the MFB-1.*

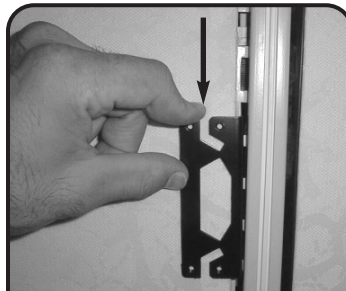

**2** Push down on bracket to lock in place.

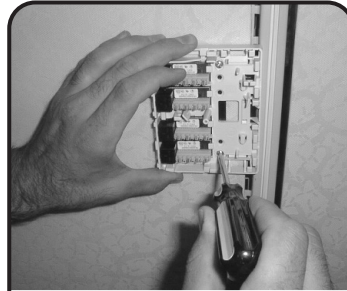

**3** A surface mount box can be mounted with the two 6-32 x 1/4 inch screws provided.

*Note: For proper alignment of surface mount box, when used in conjunction with raceway, choose the mounting holes located on the outside edge of bracket.*

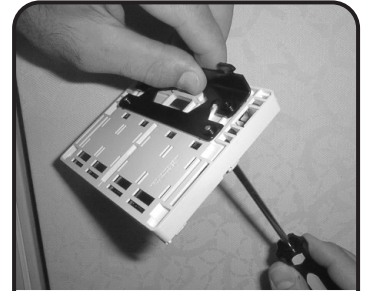

**4** Alternately, the bracket can be assembled to the surface mount box before mounting to the furniture channel.

# Modular Furniture Bracket Instructions

## Bracket Mounting for Raceway...



- 1** Prepare bracket for raceway mounting by breaking off the unused mounting hole section of bracket. The bracket will break cleanly and easily at the narrow joint by gripping both sides with pliers and bending back and forth 2 to 3 times as shown.

*Note: Version shown is the MFB-1.  
Note: Do not twist.*



- 2** Discard the unused mounting hole section and insert the tabs of the angled bracket into the furniture channel slots at the desired height.



- 3** Push down on bracket to lock in place.



- 4** Raceway can be mounted to bracket with either adhesive and/or the two 6-32 x 1/4 inch screws provided.

### Global Headquarters

Watertown, Connecticut USA  
Tel: (1) 866-548-5814

For a complete listing of our global offices visit our web site

