

RG6C Termination Instructions

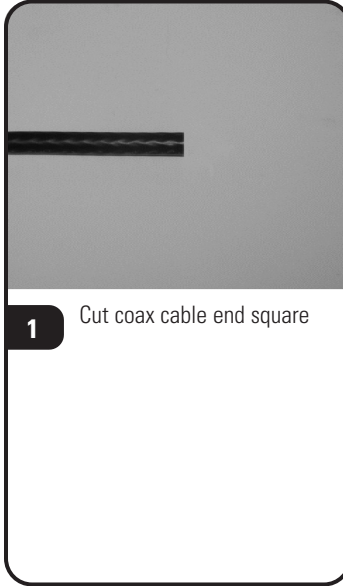

1 Cut coax cable end square

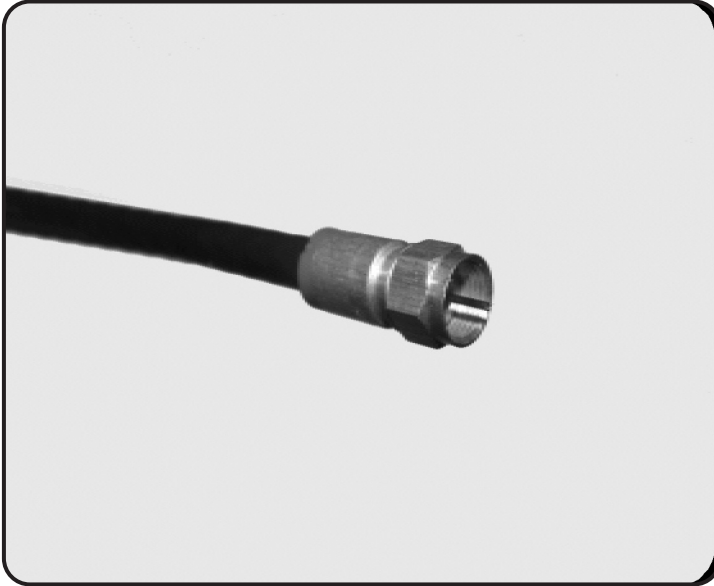
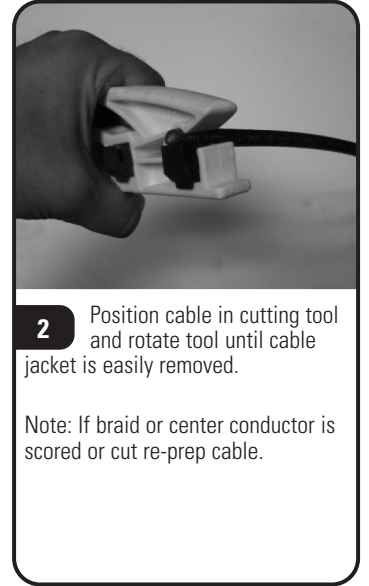

2 Position cable in cutting tool and rotate tool until cable jacket is easily removed.

Note: If braid or center conductor is scored or cut re-prepare cable.

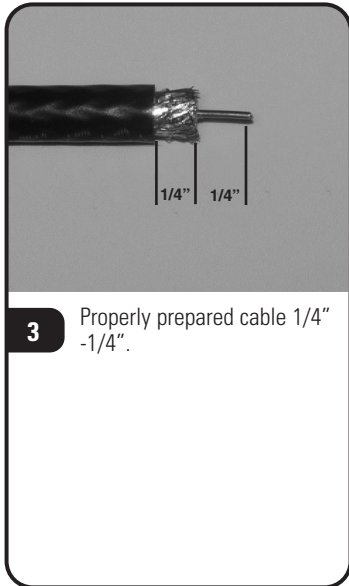

3 Properly prepared cable 1/4" - 1/4".

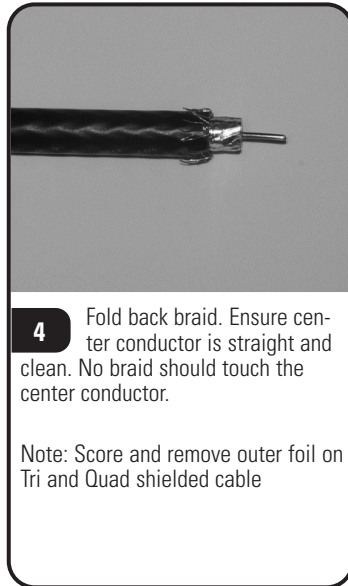

4 Fold back braid. Ensure center conductor is straight and clean. No braid should touch the center conductor.

Note: Score and remove outer foil on Tri and Quad shielded cable

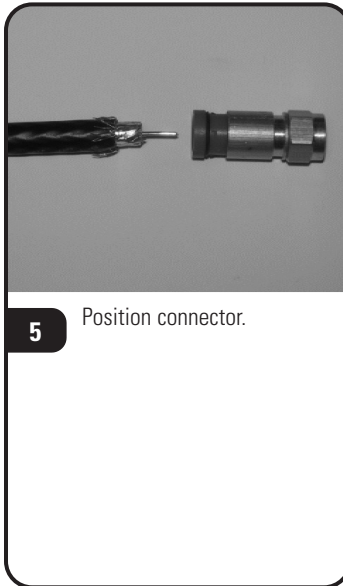

5 Position connector.

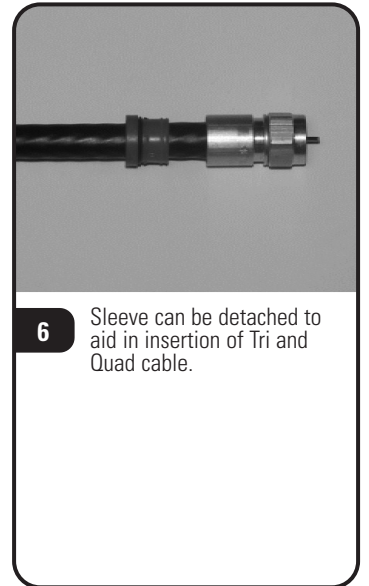

6 Sleeve can be detached to aid in insertion of Tri and Quad cable.

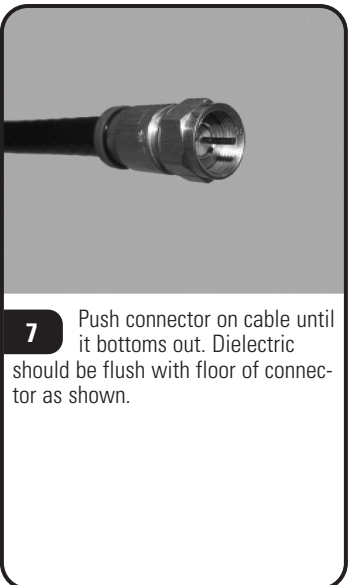

7 Push connector on cable until it bottoms out. Dielectric should be flush with floor of connector as shown.

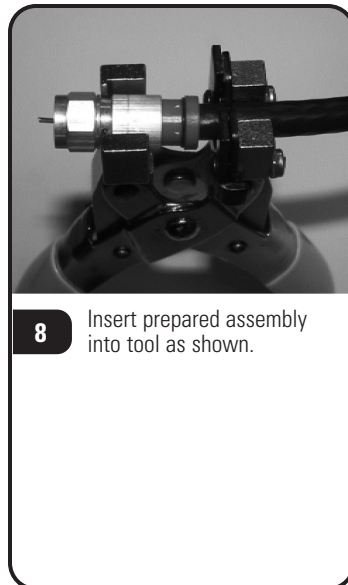

8 Insert prepared assembly into tool as shown.

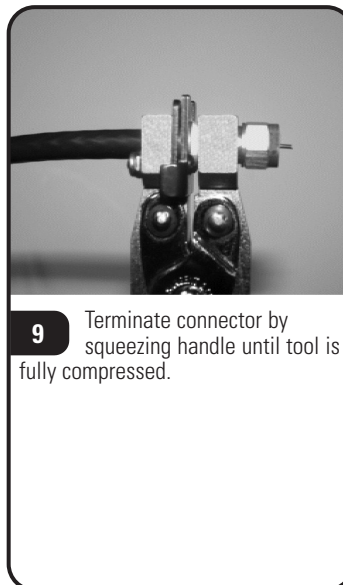

9 Terminate connector by squeezing handle until tool is fully compressed.

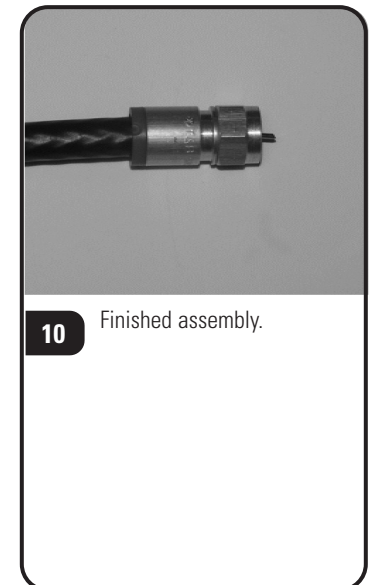

10 Finished assembly.

To assist safe installations, comply with the following:

- A. Use caution when installing or modifying telecommunications circuits.
- B. Never touch uninsulated wire terminals unless the circuit has been disconnected.
- C. Never install this device in a wet location.
- D. Never install wiring during a lightning storm.



Siemon — Asia Pacific Headquarters

Shanghai, China
Tel: (86) 21 6390 6778

Siemon — EMEA Headquarters

Chertsey Surrey, England
Tel: (44) (0) 1932 571771

Siemon — North America Headquarters

Watertown, Connecticut
Tel: (1) 866-548-5814

**Siemon — CASA Headquarters
Central & South America**

Bogota, Columbia
Tel: (011) 571 317 2121

Siemon — Japan Headquarters

Tokyo, Japan
Tel: (81) 3 5437 1580

